

# ATTENTION FRAMERS:

This home is receiving a home elevator which will require structural support for the elevator rail system and loads built into the framing of this elevator shaft.

Attached are two detailed drawings showing the layout and material needed to support this load.

For this project the Rail Support Wall is located on the:

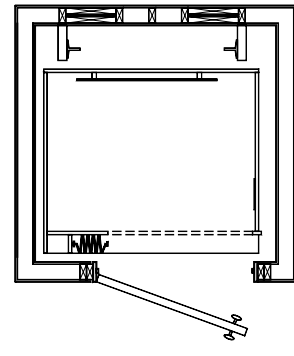
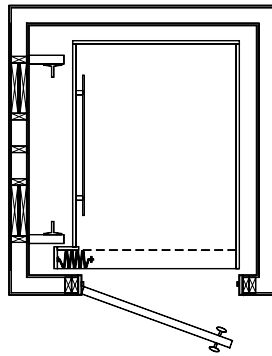
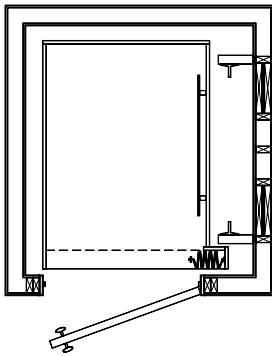

- Right Hand Wall       Left Hand Wall       Rear Wall  
(Always orient the rail wall from the lowest level served by elevator)

If you have any questions or comments,

you can call me, \_\_\_\_\_ at \_\_\_\_\_

Thank you.

I have stapled this document to the wall that will require the structural support.

THE INFORMATION CONTAINED  
HEREIN IS SOLELY OWNED BY  
RESIDENTIAL ELEVATORS, INC.  
ANY REPRODUCTION IN PART OR  
AS A WHOLE WITHOUT WRITTEN  
PERMISSION FROM RESIDENTIAL  
ELEVATORS, INC. IS STRICTLY  
PROHIBITED.



*Elevating your standard of living*



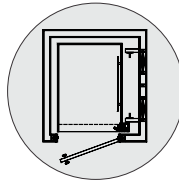

Right Hand Rail Wall (Shown)

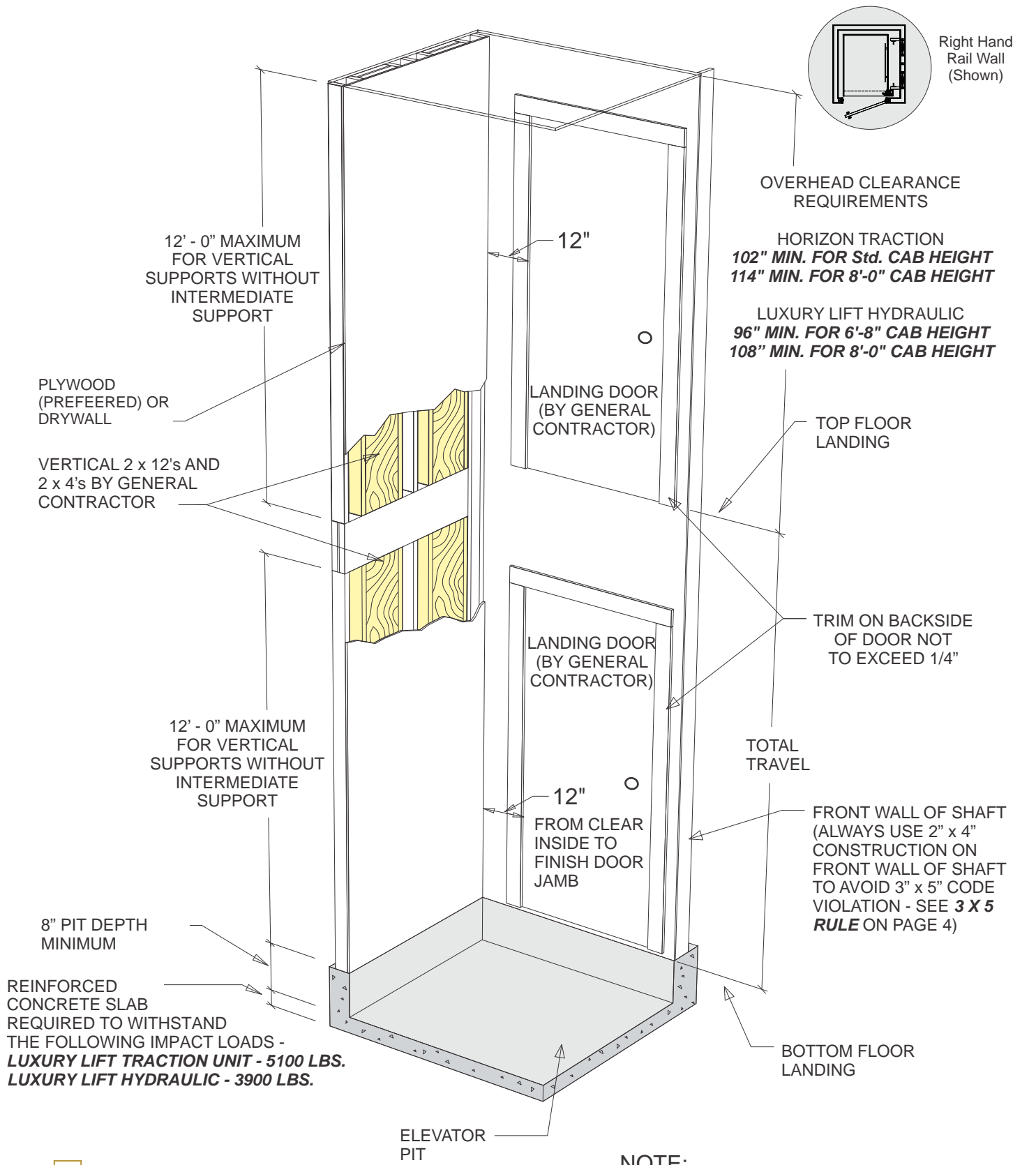

**NOTE:**  
 ALL WORK ABOVE TO BE BY GENERAL CONTRACTOR



**HOISTWAY / PIT DETAILS**

**HOR02**

March 11

# Home Elevator 3"x 5" Rule

Residential Elevators manufactures and installs a fully code compliant elevator per the ASME ANSIA17.1 National Safety Code for Elevators - Section 5.3 Private Residence Elevators.

Rule 5.3.1.4.2 (aka 3"x 5" Rule) of the above referenced code states: Clearance Between Hoistway Door(s) or Gate(s) and Landing Sill(s) and Car Door(s) or Gate(s). The clearance between the hoistway doors or gates and the hoistway edge of the landing sill shall not exceed 3 inches (76 mm). The distance between the hoistway face of the landing door or gate and the car door or gate shall not exceed 5 inches (127 mm).

**Note: Concrete block / masonry shafts and some commercial metal door frames can often create 3"x 5" Rule violations.**

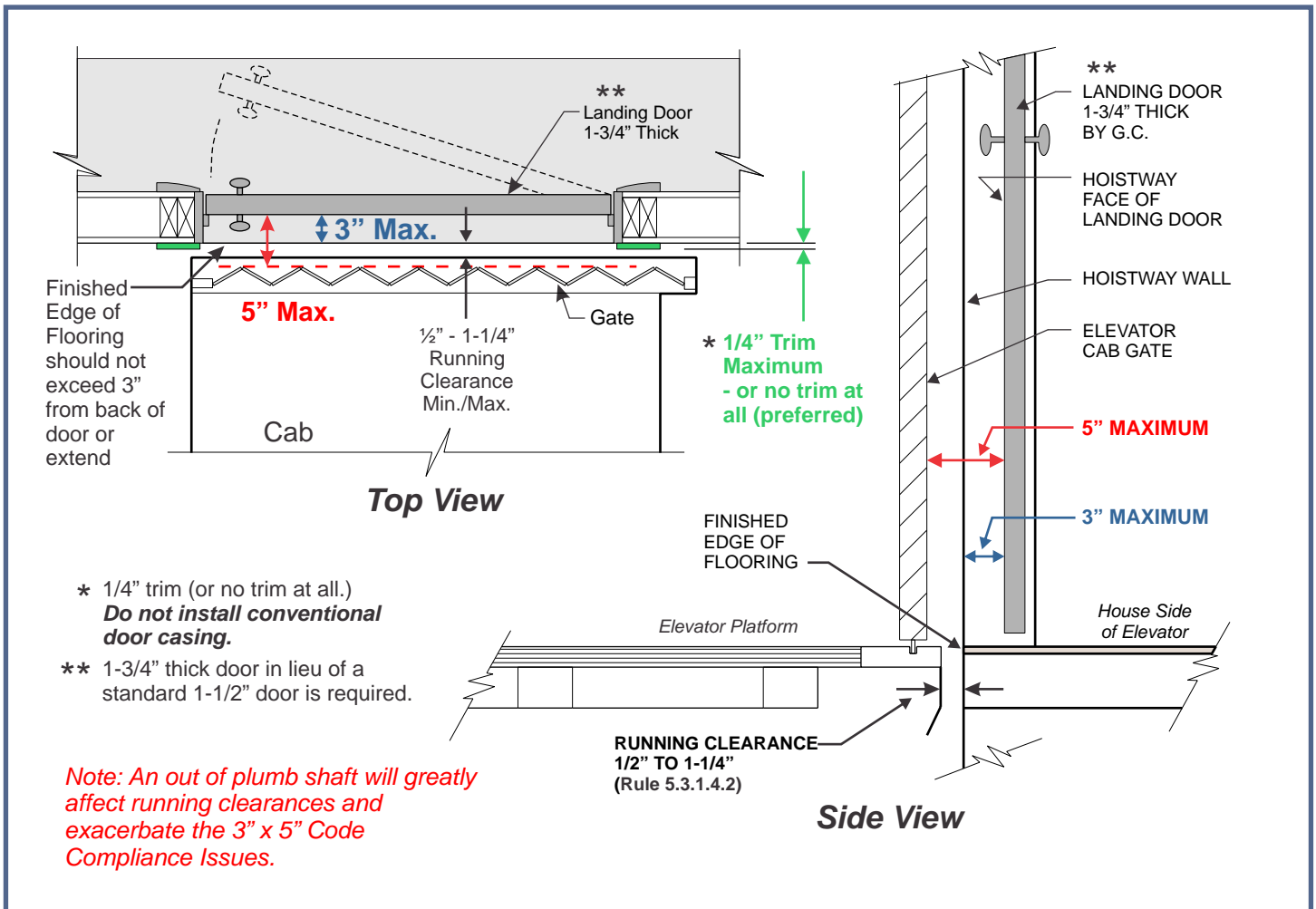

The 3"x 5" Rule is a code requirement. Residential Elevators takes pride in ensuring safety in the use of their equipment and as a policy wants to make sure all Builders, Architects, Developers, Owners / Users are aware of and adhere to this National Code.

**This is a safety issue.**

Authorized Signature

Date

February 2012